



Foreign Branch | Frankfurt, Germany
Ludwig-Erhard-Str, 30-34, 65760 Eschborn, Germany

Store | 70, Idong-ro, Buk-gu, Pohang-si, Gyeongsangbuk-do 37693

Research Institute | 1F, East Office, Gyeongbuk Economic Promotion Agency, 859,
Huijang-daero, Nam-gu, Pohang-si, Gyeongsangbuk-do 37823
T. 054-274-1003 F. 054-282-3602 E-mail. rokmc748@chol.com

MAIN INFO

Infinite development, HOLONAVI

MAIN INFO is a company specialized in developing contents/platform for autonomous driving vehicles. It is venture company that realizes and completes fusion and convergence of mobile and automobiles through motion sensors and hologram technology

CONTENS

Company Overview
Greetings and Company History 02

Company Introduction
Technological Background and Product Concepts 04
Long-term Roadmap and Company's Capabilities 06

Product Features
HOLO NAVI M10 08
HOLO NAVI M15 10
HOLO NAVI M20 12
HOLO NAVI M25/M30/M40 14

History

- 14.01.16 Established MAIN INFO Co., Ltd.
- 14.05.01 Approved as company-affiliated research institute
- 14.07.01 Verified as a venture company
- 14.08.01 Received award for support business by Developed Product Spark Design Award
- 14.10.01 Subcommittee member of hologram subcommittee of Ministry of Science, ICT and Future Planning
- 15.09.01 Won gold award in Gyeongsangbuk-do Youth CEO Entrepreneurship Competition
- 16.01.01 Technical transfer of ETRI motion sensor, Samsung Electronics hologram/voice recognition
- 16.06.01 Released Holo-Navi M10
- 17.01.01 1st in crowd funding competition sponsored by Ministry of SMEs and Startups
- 17.11.01 Subcommittee member of autonomous driving vehicles of Ministry of Land, Infrastructure and Transport
- 18.06.14 Selected as a member of Korea-Russia Economic Delegation with the President
- 18.09.05 Participated in the East Economy Forum with the Prime Minister
- 18.10.20 Selected as a member of Korea-France Economic Delegation with the President
- 18.12.11 Award Certificate from the Minister of Land, Infrastructure and Transport
- 19.01.15 Released Holo-Navi M20
- 19.04.19 Selected to go to Uzbekistan and Kazakhstan with the President
- 19.06.12 Selected to go to Poland and Sweden with the President

Certification



- 1 Agreement for technical transfer with Samsung Electronics
- 2 Technical transfer for ETRI
- 3 Patent related to motion center
- 4 Patent for fee discount based on regional advertisement
- 5 Certification as company-affiliated research institute
- 6 Verification as a venture company
- 7 Membership for Export Association
- 8 Award Certificate from the Minister of Land, Infrastructure and Transport

Albert Einstein and the Theory of Relativity

Theory of Relativity comes in two different Special relativity is called 'special' because it is applicable only on objects moving with a constant speed. This is a very rare or 'special' case because in our universe hardly anything moves with a constant speed, almost everything accelerates in our universe.

General relativity is applicable on objects moving with a constant speed as well as accelerating objects. Acceleration is a common or 'general' case in our universe.

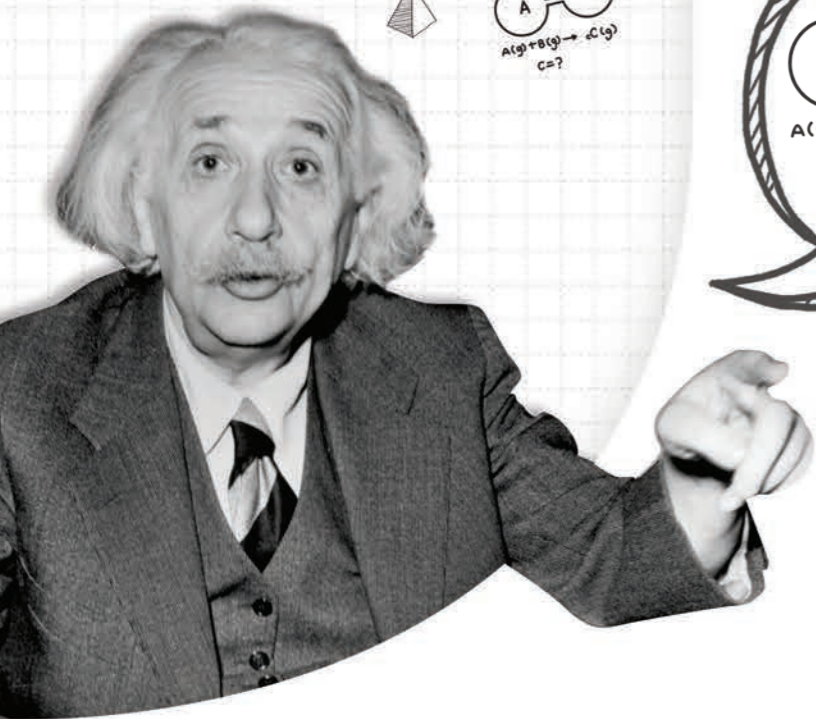
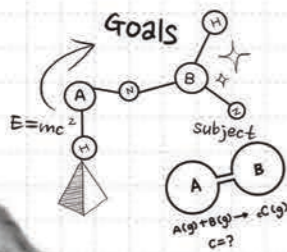

01 Technological Background



Interior

The world becomes two-dimensional when you look at the road inside the automobile



Exterior

When you look at the road outside the stopped automobile, you can see that the world is actually three-dimensional.

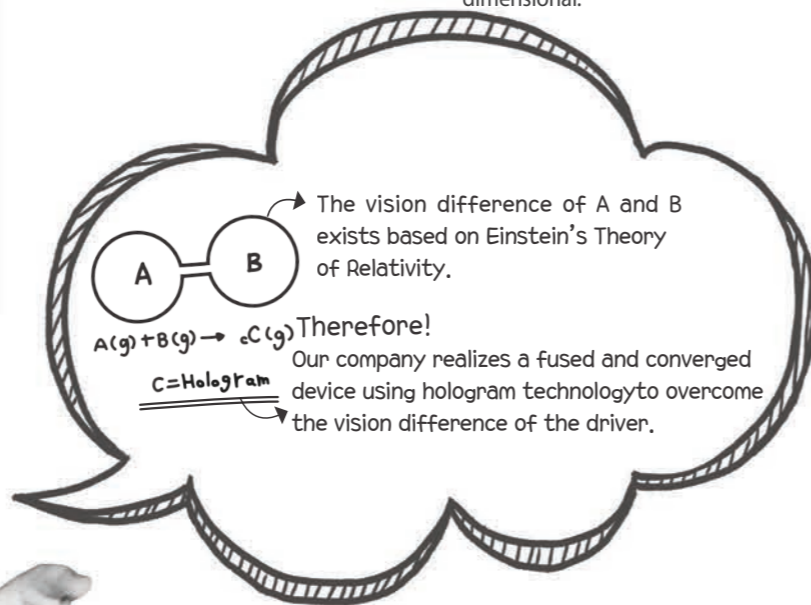

02 Product concept

Can accommodate laws, effectiveness, and safety.

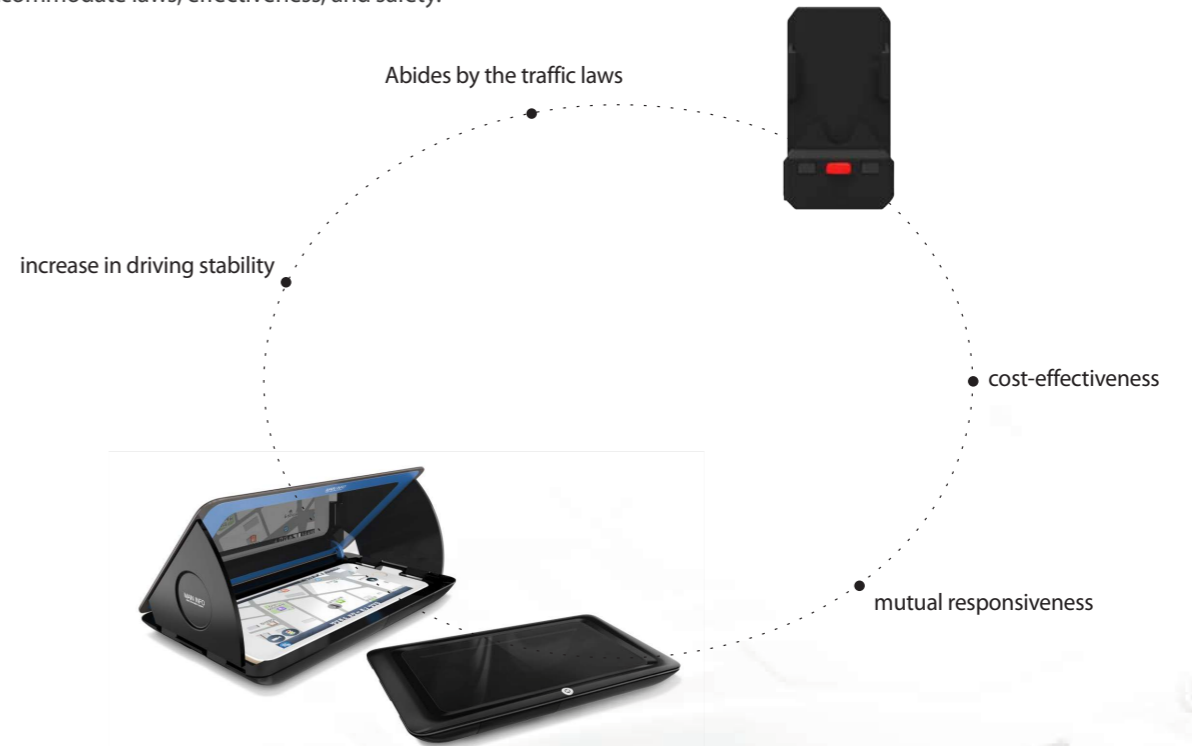

The birth of motion technology

Automobiles can crash even though vision difference is overcome through hologram. To actively reflect the cognition of the driver in emergency/dangerous zone, it is important to harmonize the motions of the driver with the automobile. The activeness of the driver can get involved more when driving, and stability can be increased through constructing fused and converged device using the motion technology.



Motion sensor technology that communicates with each other.



A company specialized in contents platform

of autonomous driving vehicles that designs fusion and convergence of new technology

Fusion of various technologies and diverse solutions based on transparent OLED, 4D hologram, and 5G communications with the rapid changes in IT environment. MAIN INFO is a company specialized in contents/platform of autonomous driving automobiles that releases new products every 2 years by fusing new technology to products after quickly receiving the new technologies.

01 Long-term Roadmap

It is a company that realizes and completes fusion and convergence of mobile and automobiles through hologram and motion sensor

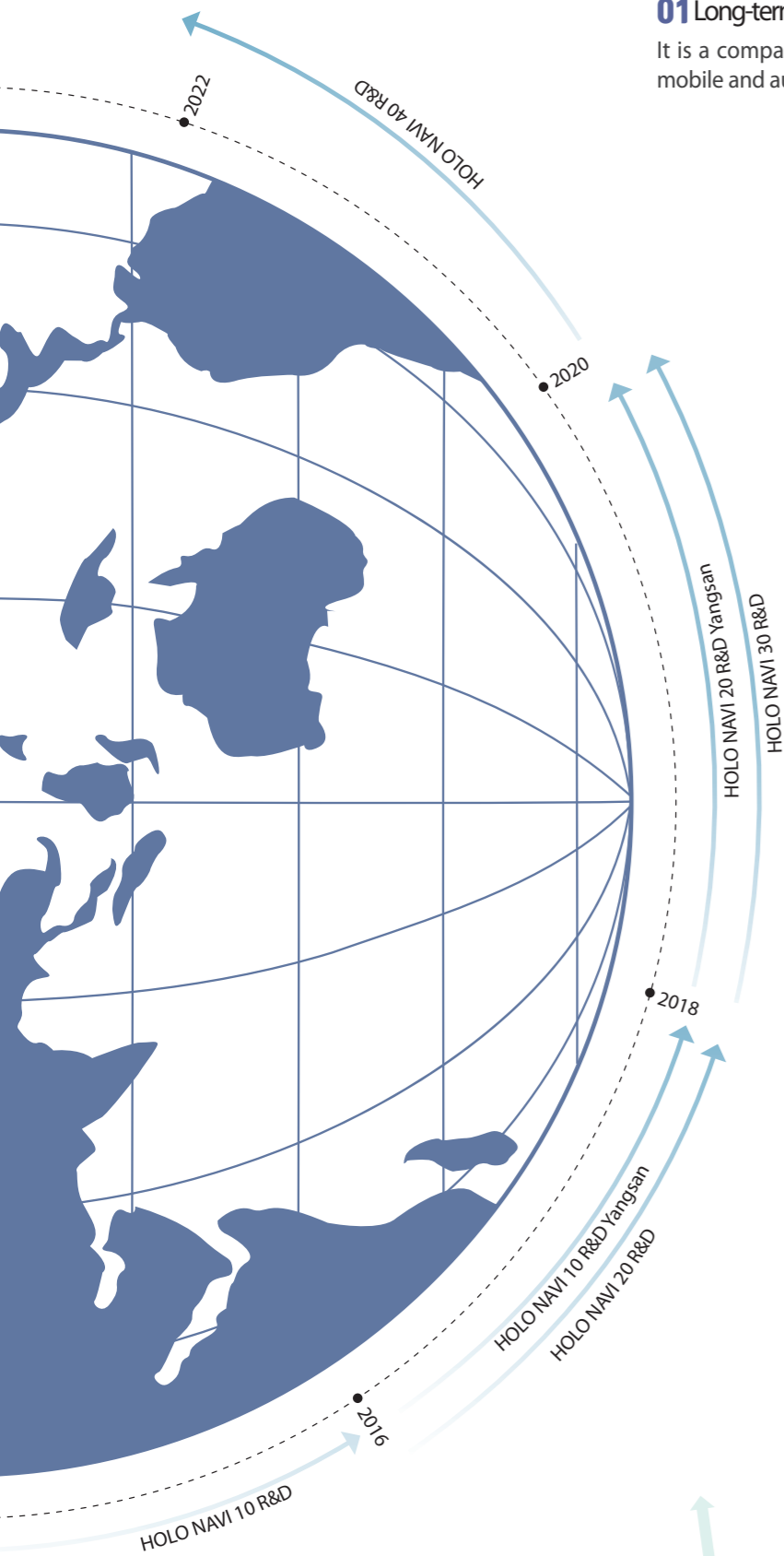

02 Company's Capabilities

It approaches not assembled car market, but tuned car market

- Selected as a member of Korea-Russia Economic Delegation with the President (2018.06), selected as a member of Korea-France Economic Delegation with the President(2018.10), selected as a member of Korea-Uzbekistan and Kazakhstan Economic Delegation with the President(2019.04), selected as a member of Korea-Poland and Sweden Economic Delegation with the President(2019.04)
- Korea-France Economic Delegation concluded MOU for 1.8 billion won on site
- Concluded MOU for 16 billion won with Croatia on site
- Concluded MOU for 1.1 billion won with Saudi Arabia on site
- Korea-Uzbekistan and Kazakhstan Economic Delegation concluded MOU for 2.3 billion won in Uzbekistan, and 3 billion in Kazakhstan on-site
- Korea-Poland and Sweden Economic Delegation concluded MOU for 10.5 billion won in Poland, and 6.4 billion won in Sweden
- Concluded MOU for 8.7 billion with Ho Chi Minh City on site.





01 Product features

- 1 Device that projects parts of necessary information from dashboard such as speed and navigation on the front window
- 2 Makes the driver focus on driving by reducing the eye movement with HUD, and prevents accidents with safe driving effectively.
- 3 Solves vision diversion from using smart devices while driving
- 4 Extemporaneous hologram through reflection and refraction of light, and use of application on smartphone screen
- 5 Increase the visibility of navigation through fusion and convergence of hologram and mobile devices
- 6 Can be attached to every type of automobile without additional construction
- 7 Decrease expense in hardware by using smart devices
- 8 There is no interference by the sun with special film on our product

HUD:Head Up Display



02 Distinctions from other products

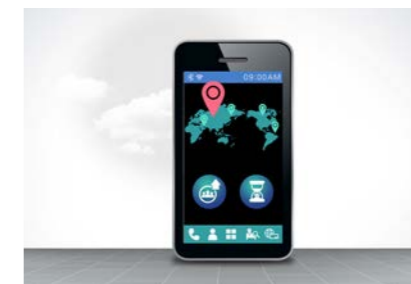

The picture is not clear due to interference of the sunlight when used in daytime, and the visibility is lacking due to double focus. Visibility is much better with no ghosting and interference of the sunlight through patented technology and special film.

Does not require additional expensive device, as the smartphone app screen of the smartphone is projected on the product through hologram

Verified technology, with related patents applied and registered.

Comfortable driving with no obstacle

As the navigation applications have developed, many drivers now use navigation on their smartphones. However, the batteries die faster as the navigation app has to be on, and the inconvenience of the cable is great. Hence, our company developed wireless charged device for driving assistance.

01 Product Features

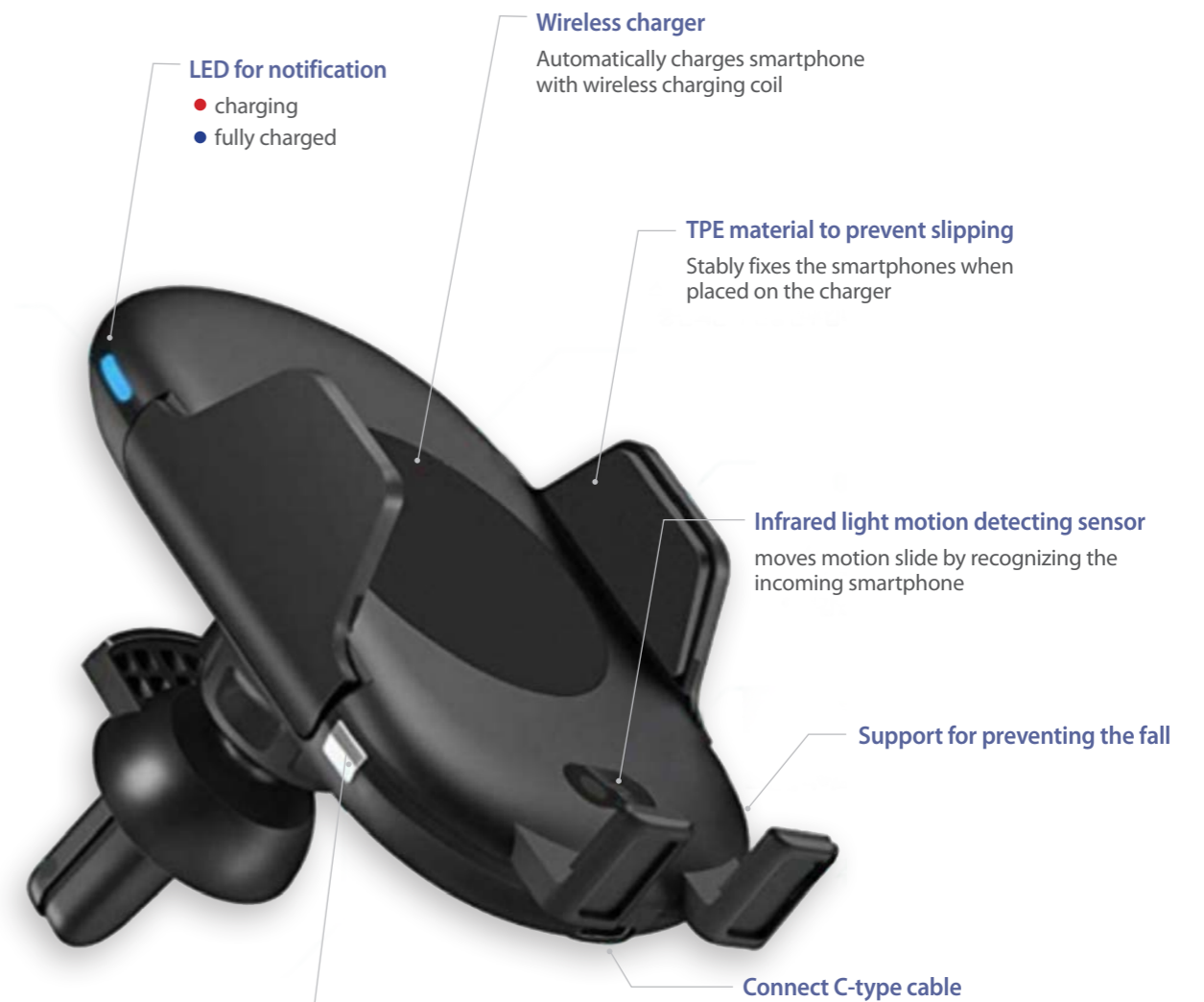

Manual touch button

a button that can manually activate automatic sensor to take smartphone out by touching it



01 Product Introduction

is a product which the driver on the automobile defines where to place the mobile device, and strives for both safety and efficiency of driving.

02 Product Features

- Realized phone(answer phone)/message(refusal message) using motion sensor while driving
- Operates Melon player by applying motion recognition function
- Prevents not keeping eyes forward while driving, abides by the traffic laws
- Utilizes smartphone (app + motion sensor)
- Has left/right sensors Left ▶ right (Yes)
Left ▶ right (No)



03 Product Structure



01 HOLO-NAVI M25



Rollable type OLED-based intelligent driver assistance device
The curved rollable display allows all car to be equipped with genuine navigation.
(Realization of universality, customized order production by smart factory method)

02 HOLO-NAVI M30

C-ITS/WAVE Device(Contents for autonomous driving automobiles)

Recognizes the situation of the traffic

- Collects automobile data based on the location
- Provides traffic information based on location
- Smart fee payment
- Information on dangerous zone on the road
- Information on the surface and weather
- Supports driving on the road under construction
- Warns danger of violating the signal on the crossroads
- Turning right safely
- Manages operation of the bus
- Information on Yellow Bus
- Speed control in school and silver zones
- Warns collision with pedestrians
- Supports prevention of crashing into other cars
- Warns approach of emergency vehicles
- Warns emergency on the automobile



Road traffic situation awareness
(Ad platform that receives adverts around)

03 HOLO-NAVI M40

AUTO SAR Control Device(Platform for autonomous driving automobile)



MAIN INFO is together with UNICEF

While MAIN INFO is a small business, every employee including CEO supports some of their salaries and profits to UNICEF.

